

HSV⁺ Filter Housing

- industrial vent



- Industrial vent housings
- Available in ATEX version
- Beverage, pharmaceutical and industrial surface finishes available
- Available in various connection types

Specification

Materials of Construction

- Housing: 316L Stainless Steel
- Seals: EPDM FDA, PTFE FDA, Silicone FDA, Viton FDA

Note: Seal used only to position bowl clamp arrangement.

Working Condition PED 97/23/EC			Volume [litres]				
Variant	State	Temperature	01K	011	012	013	014
Standard	Gas / Vapour	150 °C [302 °F]	1.6	2.8	4.7	6.6	8.5
ATEX	Gas / Vapour	135 °C [275 °F]	1.6	2.8	4.7	6.6	8.5

Surface Finish

- Industrial Finish
 - Internal: As Welded, Pickled & Passivated
 - External: Polished 0.8 µm Ra
- Beverage Finish
 - Internal: Polished 0.4 µm Ra
 - External: Polished 0.25 µm Ra
- Pharmaceutical Finish
 - Internal: Polished 0.4 µm Ra and Electropolished
 - External: Polished 0.25 µm Ra

Welding

All assembly welds are full penetration. All welds are crevice and undercut free. Weld finish & detail drawings available upon request.

Design Basis

ATEX 94/9/EC (where applicable)

Physical Characteristics

Bowl Height	Dimensions (mm)			Typical Weight (Kg)		
	'A'	'B'	'C'	Bowl	Head	Total
5" (125 mm)	132	274	194	0.9	2.6	4.0
10" (250 mm)	132	424	313	1.5	2.6	4.6
20" (500 mm)	132	674	561	2.5	2.6	5.6
30" (750 mm)	132	919	809	3.5	2.6	6.6
40" (1000 mm)	132	1169	1057	4.5	2.6	7.6

Dimensions shown are for a vessel with 1 1/2" BS4504 DIN 2633 outlet port. For other formats, please contact Parker domnick hunter.

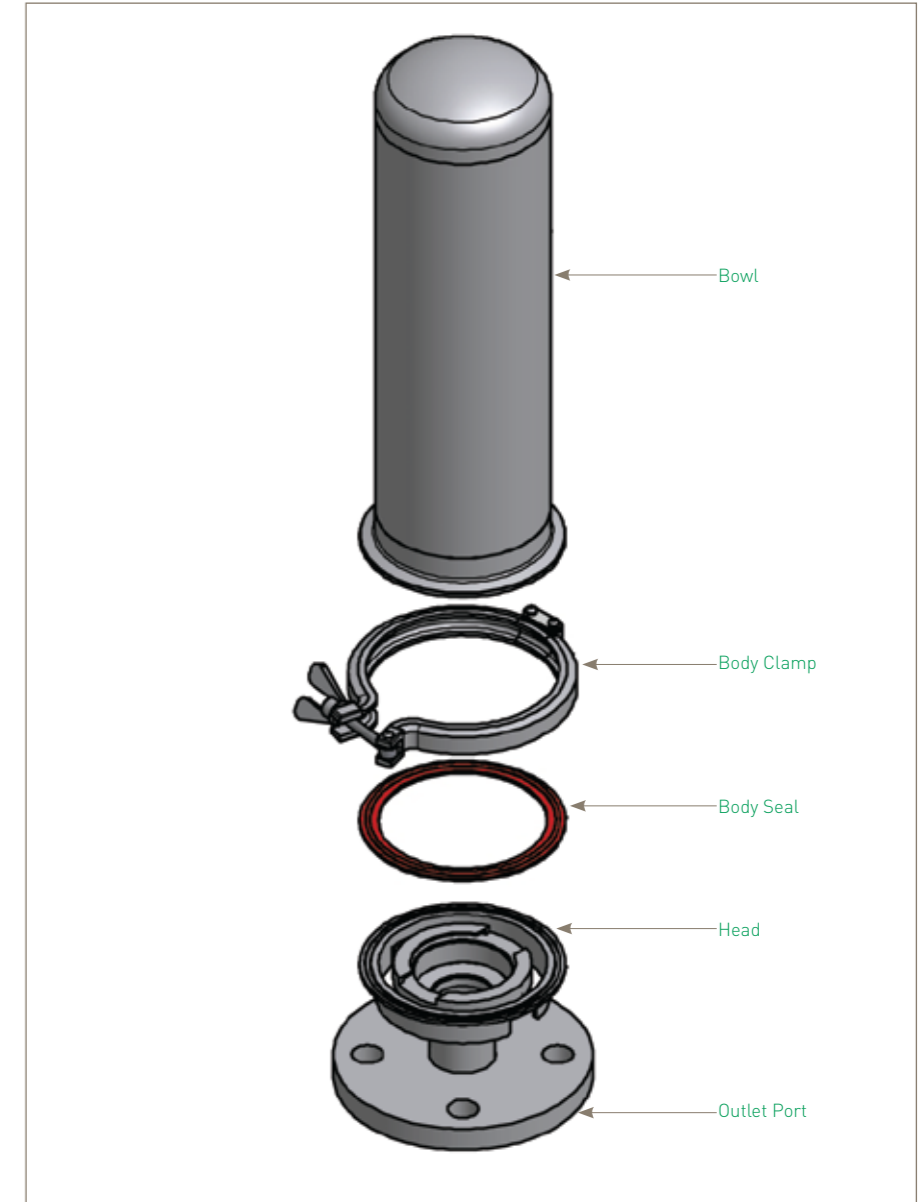
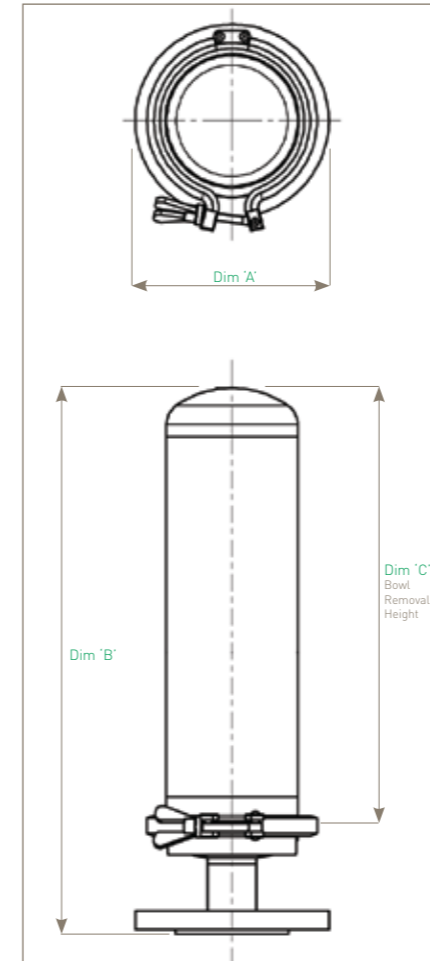

Ordering Information

HSV	01									
Code Vessel Class	Code Length (Nominal)	Code Connection Size	Code Standard	Code Cartridge	Code Seal	Code Surface Finish	Internal	External	Code Tagged	
DH Standard AT ATEX	K 5" (125 mm) 1 10" (250 mm) 2 20" (500 mm) 3 30" (750 mm) 4 40" (1000 mm)	C 2" (50.8 mm) Y 1 1/2" (38.1 mm)	B BSPP (F) D DIN11851(M) F ANSI RF150 L BS4504 DIN2633 N NPT (F) T Tri-Clamp W BS / ISO Pipe	C 226	E EPDM P PTFE S Silicone V Viton	B Beverage I Industrial P Pharmaceutical	0.4 µm As Welded 0.4 µm EP	0.25 µm 0.8 µm 0.25 µm	T Yes X No	

For Tagged Options customer identification numbers required at time of ordering

PROSEP FILTER SYSTEMS LTD
Unit G19
River Bank Way
Lowfields Business Park
Elland
West Yorkshire
HX5 9DN

Tel: 01422 377367

Fax: 01422 377369

Email: enquiries@prosep.co.uk

www.prosep.co.uk

Map and Directions to Prosep Filters Limited



Leave M62 at Junction 24.

At roundabout adjacent to Cedar Court Hotel take 2nd exit onto dual carriageway (A629), signposted Halifax.

Take 1st exit slip road.

At roundabout at end of sliproad, take 3rd exit off.

This is the entrance to Lowfields Business Park.

Proceed straight over 1st roundabout.

At next roundabout take 2nd exit onto River Bank Way - Prosep Filters can be found on the left after the S-bend.

[Link to Google Maps](#)