

# PROSEP FILTER SYSTEMS LTD

## AQUA BIG HOUSINGS



### Specification:

Head: Filled Polypropylene

Bowl: Filled Polypropylene

O-Ring: Nitrile

Working Pressure: 6 bar maximum

Working Temperature: 50°C

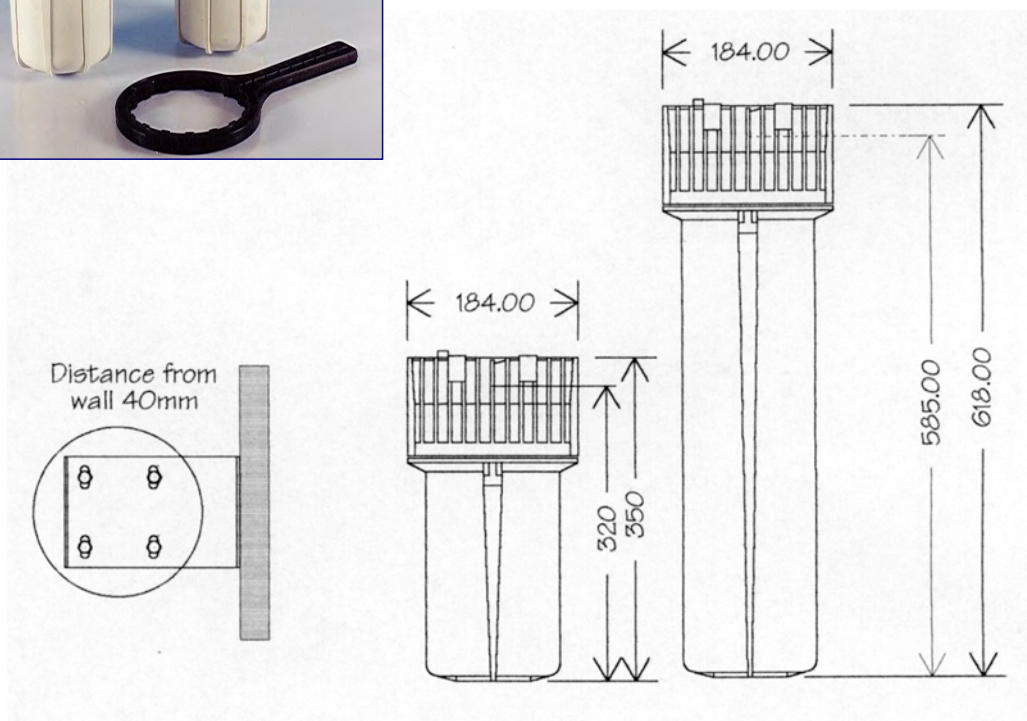

Part Number	Connection	Cartridge Length	Bracket	Bowl Spanner	O-Ring (NITRILE)
A1050005	1" BSP(F)	10"	AQACPN020020	AQACA6010090	AQAC0011
A1050020	1 1/2" BSP(F)	10"	AQACPN020020	AQACA6010090	AQAC0011
A1050010	1" BSP(F)	20"	AQACPN020020	AQACA6010090	AQAC0011
A1050040	1 1/2" BSP(F)	20"	AQACPN020020	AQACA6010090	AQAC0011

UNIT G19, RIVER BANK WAY, LOWFIELDS BUSINESS PARK,  
ELLAND, WEST YORKSHIRE HX5 9DN

TEL: 01422 377367 FAX: 01422 377369

Email: [sales@prosep.co.uk](mailto:sales@prosep.co.uk) Web: [www.prosep.co.uk](http://www.prosep.co.uk)

# PROSEP FILTER SYSTEMS LTD

## AQUA BIG CARTRIDGES



### STRING WOUND CARTRIDGE

Precision wound polypropylene filter cartridges on a polypropylene core (other options available). 10" or 20" lengths boxed in quantities of 12 for 10" cartridges and 6 for 20" cartridges.

Micron ratings available: 1, 5, 10, 25, 50, 75 & 100

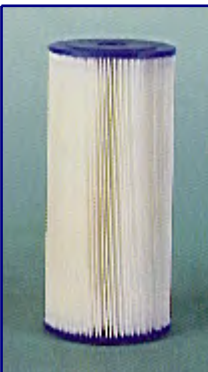

### CELLULOSE AND POLYESTER CARTRIDGES

**CP5-BB** (Pleated cellulose/polyester rated at 5 micron). These cartridges are constructed from a unique polyester and cellulose fibre blend media. The pleated block has been immersed in vinyl plastisol to create unitized end cap and gasket. The innovative media ensures high flow rates with low pressure drops, whilst maintaining extremely high dirt loading capacity and efficiencies.

**PLPO-10-30AB & PLPO-10-50 AB** (Pleated cellulose cartridges rated at 30 and 50 microns respectively). These cartridges are constructed from a non-woven polyester fabric media with vinyl plastisol end caps and a polypropylene core.



### GRADED DENSITY CARTRIDGES

Both the pre- and post filter components of these cartridges are separate gradient density filters. Gradient density filters reduce large particles, which would blind-off ordinary surface filters, on their outer layers while reducing finer particles on their inner layers. The design maximises utilisation of the filtration media.

Graded density cartridges are made from bacteria resistant pure polypropylene which makes them ideal for all municipal, rural, residential and commercial applications.

Micron ratings available: 1, 5, 10, 20, 30 & 50



### ACTIVATED CARBON CARTRIDGES

Activated carbon filters are designed for effective reduction of unwanted taste and odour, such as chlorine. They are engineered to allow water to enter one end and pass through the entire bed of carbon before exiting through the other end. This allows the water to be in contact with the carbon for a maximum length of time, ensuring maximum adsorption. An internal expansion pad is added to minimise channeling or bypass. A nominal 20 micron post filter is incorporated to reduce carbon fines and other suspended particles.

UNIT G19, RIVER BANK WAY, LOWFIELDS BUSINESS PARK,  
ELLAND, WEST YORKSHIRE HX5 9DN  
TEL: 01422 377367 FAX: 01422 377369  
Email: [sales@prosep.co.uk](mailto:sales@prosep.co.uk) Web: [www.prosep.co.uk](http://www.prosep.co.uk)