



# Demi HSV Filter Housing

- vent housing

- Direct connection to tank boss allows housing to be self-supportive
- Corrosion resistant 316L stainless steel
- Easy assembly and maintenance



## Specification

### Materials of Construction

- Housing: 316L Stainless Steel
- Seals: Silicone FDA

### Surface Finish

- Internal: Polished 0.8 µm Ra
- External: As welded

*All finishes pickled & passivated.*

### Welding

All assembly welds are full penetration. All welds are crevice and undercut free.

*Weld finish & detail drawings available upon request.*

### Certification

Supplied as standard with vessel inspection certificate.

### Material Test Certification

EN10204 3.1 supplied upon request.

Working Condition PED 97/23/EC		Volume (litres)	
State	Temperature	01A	01B
Gas / Vapour	150 °C (302 °F)	0.75	0.50

### Recommended Operation Guidelines Sizing

Sizing vent vessels particularly for vacuum sensitive tanks can require specialist advice. It is important that VENT housings are sized on maximum gas flow capacity under actual operation conditions.

### Vacuum Protection

Where a tank is vacuum sensitive, there is a risk of tank collapse. In such cases the fitting of an appropriately rated bursting disc (or similar) and, if necessary a pressure relief valve, is highly recommended.

## Physical Characteristics

Bowl Height	Dimensions (mm)		Typical Weight (Kg)
	'B'	'C'	
A Size 5" (125 mm)	195	130	1.0
B Size 2 1/2" (65 mm)	140	70	0.9

Dimensions are based on illustration shown [HSVDH01ABT-T-S].  
For accurate dimensions, please contact Parker domnick hunter.

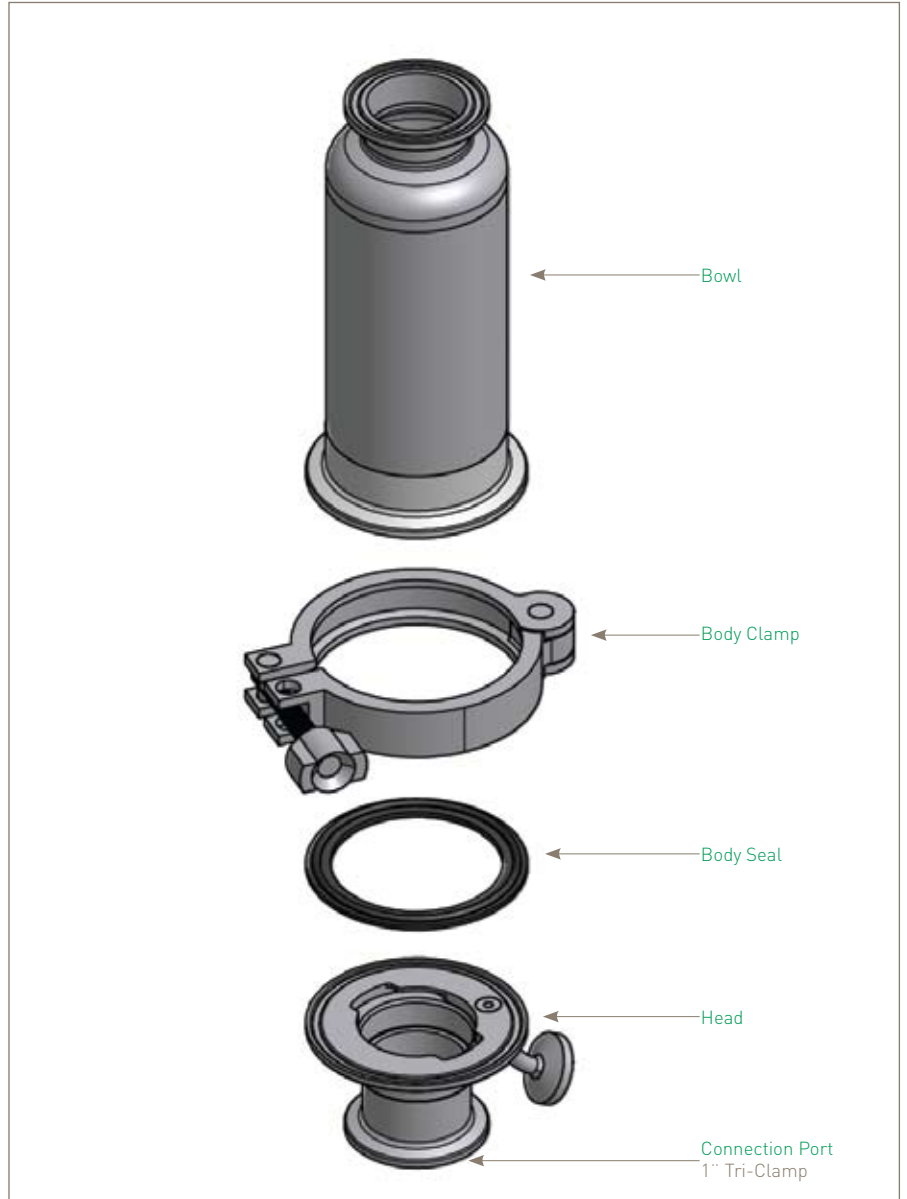
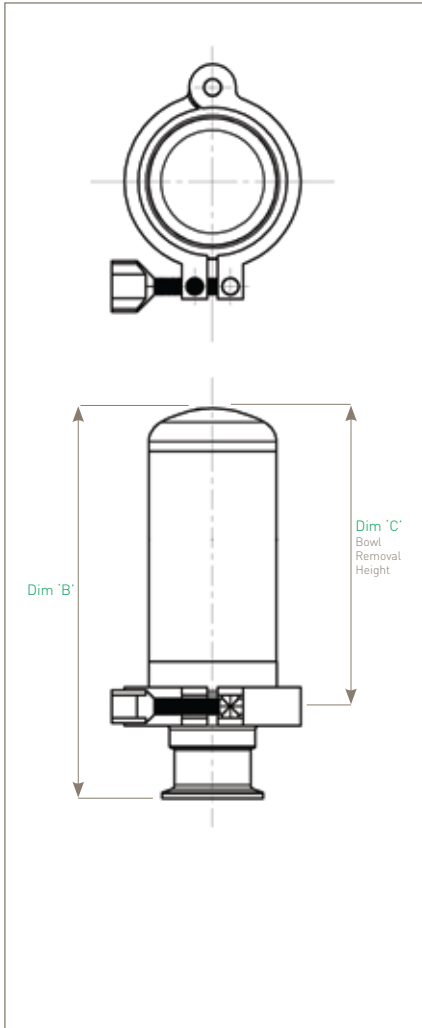

## Ordering Information

Code   Vessel Class	Code   Length (Nominal)	Code   Connection Size	Code   Standard	Code   Cartridge	Code   Seal
DH Vent Housing	A 5" (125 mm) B 2 1/2" (65 mm)	B 1"	T Tri-Clamp	T 126	S Silicone

Note: For accessories, i.e. gauges, please contact Parker domnick hunter - Process Division for full availability.

For additional features, Parker domnick hunter offer this housing as part of its Standard PLUS Range.  
Please see HSV® datasheet for more information.

Parker domnick hunter has a continuous policy of product development and although the Company reserves the right to change specifications, it attempts to keep customers informed of any alterations. This publication is for general information only and customers are requested to contact our Process Filtration Sales Department for detailed information and advice on a products suitability for specific applications. All products are sold subject to the company's Standard conditions of sale.

PROSEP FILTER SYSTEMS LTD  
Unit G19  
River Bank Way  
Lowfields Business Park  
Elland  
West Yorkshire  
HX5 9DN

**Tel: 01422 377367**

**Fax: 01422 377369**

Email: [enquiries@prosep.co.uk](mailto:enquiries@prosep.co.uk)

[www.prosep.co.uk](http://www.prosep.co.uk)

**Map and Directions to Prosep Filters Limited**



Leave M62 at Junction 24.

At roundabout adjacent to Cedar Court Hotel take 2nd exit onto dual carriageway (A629), signposted Halifax.

Take 1st exit slip road.

At roundabout at end of sliproad, take 3rd exit off.

This is the entrance to Lowfields Business Park.

Proceed straight over 1st roundabout.

At next roundabout take 2nd exit onto River Bank Way - Prosep Filters can be found on the left after the S-bend.

[Link to Google Maps](#)